

- NOTES:**
- WHEN INSTALLING PROPOSED WASTEWATER SEWERS ON LEILA AVE TAKE CAUTION WHEN CROSSING EXISTING RESIDENTIAL WATER SERVICES.
 - CONTRACTOR SHALL VERIFY ELEVATION OF EXISTING SEWER SERVICES AT PROPOSED DOWNSTREAM CONNECTION LOCATIONS PRIOR TO INSTALLATION OF COLLECTOR WWS TO ALLOW FOR CHANGES OF GRADE TO THE COLLECTOR WWS.
 - EXISTING CS SERVICE TO BE REPURPOSED FOR LDS SERVICE.
 - FOR CONCRETE COLLAR DETAIL OF PVC/CONCRETE PIPE TRANSITION SEE DWG. 13685.
 - CASING PIPE SPECIFICATION:
 - OUTSIDE DIAMETER: 914mm
 - WALL THICKNESS: 13.5mm
 - PIPE MATERIAL: STEEL
 - ASTM A252 GR2
 - PROTECTION: N/A
 - JOINT: WELDED
 - INSTALLATION: AUGER BORING
 - CARRIER PIPE TO BE SUPPORTED BY MANUFACTURED CASING SPACERS. CASING ENDS TO BE SEALED WITH MANUFACTURED NEOPRENE RUBBER END SEALS.

NOTE: CHAINAGES SHOWN ALONG S_P OF LEILA AVENUE

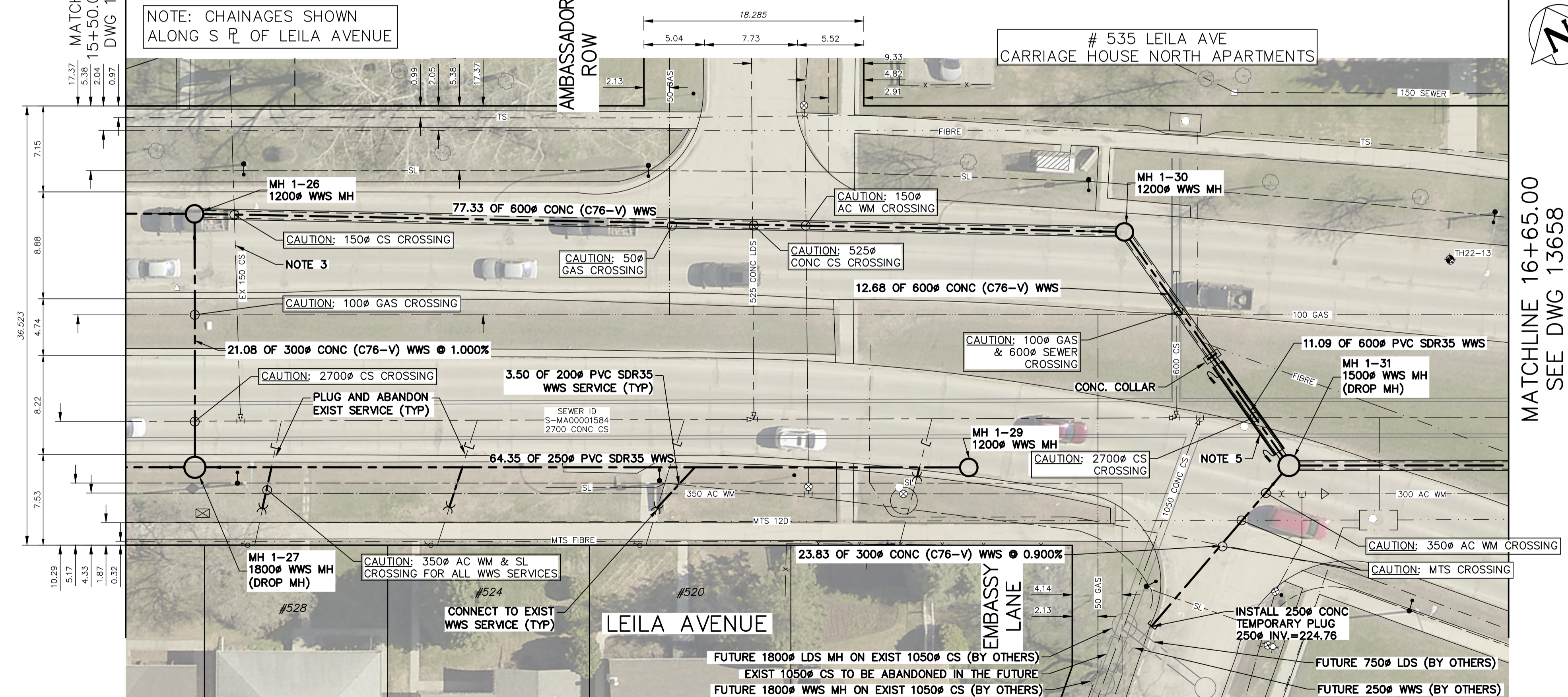

SEWER SERVICE INFORMATION					
ADDRESS	STATUS	SIZE (mm) MATERIAL	COORDINATES AT JUNCTION	COORDINATES AT PROPERTY	REMARKS
-	ACTIVE	150 UNKNOWN	N=5534423.46 E=634291.60	UNKNOWN	MTS MH DRAIN?
#52 EMBASSY LN	ACTIVE	150 UNKNOWN	N=5534439.16 E=634267.88	N=5534430.77 E=634260.97	NONE
#520 LEILA AVE	ACTIVE	200 UNKNOWN	N=5534447.83 E=634249.20	N=5534439.72 E=634241.87	NONE
#524 LEILA AVE	ACTIVE	200 UNKNOWN	N=5534455.08 E=634233.60	N=5534447.08 E=634226.17	NONE
#528 LEILA AVE	ACTIVE	200 UNKNOWN	N=5534461.94 E=634218.81	N=5534453.52 E=634212.42	NONE
#549/553 LEILA AVE	ACTIVE	150 CONC	N=5534463.38 E=634215.73	N=5534487.43 E=634226.14	NONE

SEWER JUNCTION INFORMATION FROM SEWER VIDEO INSPECTION		
SEWER ID S-MA00001584		
DISTANCE FROM MH ID S-MH00001331	DIAMETER	CLOCK
152.2	150	11
155.6	200	2
171.9	200	2
189.1	200	2
209.7	150	2
229.1	400	9
232.0	400	3

SEWER JUNCTION INFORMATION FROM SEWER VIDEO INSPECTION		
SEWER ID S-MA00001634		
DISTANCE FROM MH ID S-MH00001366	DIAMETER	CLOCK
11.7	150	1



FOR INDEX PAGE SEE DWG 13643

METRIC
WHOLE NUMBERS INDICATE MILLIMETRES
DECIMALIZED NUMBERS INDICATE METRES

SCALE 1:250 (A1)

WARNING

IF POWER EQUIPMENT OR EXPLOSIVES ARE TO BE USED FOR EXCAVATION ON THIS PROJECT THE CONTRACTOR MUST:

- NOTIFY THE GAS COMPANY OF THE PROPOSED LOCATION OF EXCAVATION.
- TAKE PRECAUTION TO AVOID DAMAGE TO GAS COMPANY INSTALLATIONS.

SEE PROVINCIAL REGULATION 210/72 FOR DETAILS

LOCATION APPROVED UNDERGROUND STRUCTURES

SUPV. U/G STRUCTURES COMMITTEE DATE

NOTE:
LOCATION OF UNDERGROUND STRUCTURES AS SHOWN ARE BASED ON THE BEST INFORMATION AVAILABLE BUT NO GUARANTEE IS GIVEN THAT ALL EXISTING UTILITIES ARE SHOWN OR THAT THE GIVEN LOCATIONS ARE EXACT. CONFIRMATION OF EXISTENCE AND EXACT LOCATION OF ALL SERVICES MUST BE OBTAINED FROM THE INDIVIDUAL UTILITIES BEFORE PROCEEDING WITH CONSTRUCTION.

VERTICAL DATUM: CGVD28 (HT2.0 Geoid)
HORIZONTAL DATUM: NAD83 (June 1990), Zone 14

NO.	ISSUED FOR CONSTRUCTION	DATE (YYYY/MM/DD)	BY
0	ISSUED FOR CONSTRUCTION	2026/03/10	MID

KGS GROUP

DESIGNED BY	MID	CHECKED BY	TLE
DRAWN BY	GEL	APPROVED BY	RBO
SCALE:		RELEASED FOR CONSTRUCTION	
HORIZONTAL	1:250	DUANE BAKER	
VERTICAL	1:50	DATE	2026/03/12

PLOT DATE:

ENGINEER'S SEAL

ORIGINAL DRAWING SEALED BY:
M.A. IANKOVA-DEDOVA
2026/03/11

CONSULTANT DRAWING NUMBER
C1-16

THE CITY OF WINNIPEG
WATER AND WASTE DEPARTMENT
ENGINEERING SERVICES DIVISION

ARMSTRONG SEWER RELIEF WORKS
CONTRACT 1
LEILA AVENUE
43.1 W OF AMBASSADOR ROW TO
53.6 E OF AMBASSADOR ROW

SHEET 16 OF 46
CITY DRAWING NUMBER
13657